

NEP EUROPE: FACTSHEET

NEP NL

Studio 2

NEP The Netherlands
André van Duinboulevard 4
1217 Hilversum, the Netherlands

sales@nepgroup.com
+ 31 35 773 15 00



WWW.NEPGROUP.COM

FLOORPLAN STUDIO 2 MEDIA PARK

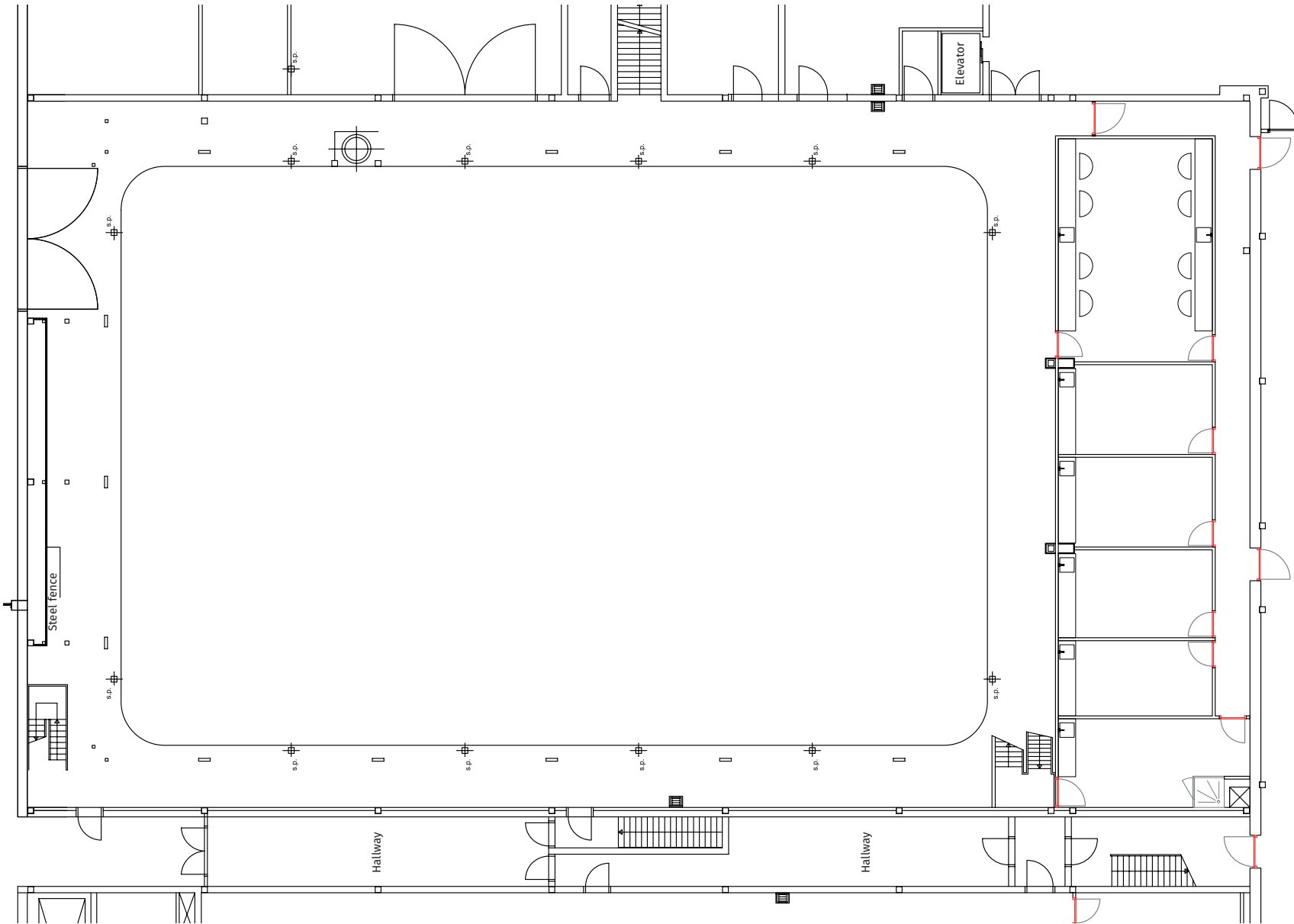

Length 30 m x width 20 m
inner curtain rail

STUDIO 2 SPECIFICATIONS

Large, turnkey equipped studio: ideal for short-term productions

GENERAL	
Dimensions	30 m x 20 m
Effective floor area	600 m ²
Free height	8.85 m
Air conditioning	Available, both cooling and heating
Capacity	358 people
Parking	1400 spaces Paid parking on Parking deck A Cost: € 1.50 per 55 minutes or € 7.50 per day
Security	Present during productions in the building. On request, dedicated for production
Wardrobe	Available
Loading and unloading	Covered in the hallway decor
Internet facilities	WiFi with password
Dedicated Internet connection	On request

TECHNICAL SPECIFICATIONS	
Floor finish	Smooth cast floor, can be painted
Maximum floor load	800 kg / m ²
Maximum axle load	5 tons
Maximum wheel load	2.5 tons
Decor doors	5.00 m x 3.70 m (w x h)
Maximum grid capacity	50 kg / m ²
Curtain rails	Height 7.00 m
Black curtain	All around, height 6.90 m
Electricity supply	In the dimmer area: 1 x 125A On floor: 5 x 16A CE + 2 x 63A + 2 x 32A On grid: 1 x 125A + 2 x 32A

TECHNICAL SPECIFICATIONS	
Fixed dimmers 5kw	Use on request
Rigging / light grid	On request
Light connection field	Multi-connectors in the dimmer area: 12 x ceiling, 12 x floor, Ethernet and DMX
Other	Water point and drainage

PRODUCTION FACILITIES	
Production	Studio 2 is connected to Cloud Production technology
LiveCenter	The studio 2 Cloud Production is connected to the LiveCenter In addition to various incoming and outgoing connections and MCR services, the LiveCenter provides a variety of additional media services, including recording, play-out, graphics and EVS services
Post-production	The studio 2 Cloud Production is connected to the post-production platform. In addition to live ingest and editing, all preparatory post activities can be connected to studio activities in a seamless workflow.

OTHER AREAS	
Production office	Equipped with four workstations and live monitor
Dressing rooms	1 large dressing room 6 dressing rooms: seating area, makeup position and live monitor. The dressing rooms include a toilet block with a disabled toilet
Makeup room	Makeup room with 8 positions and live monitor
Reception area	NEP central hall with toilets, reception and live monitor
Foyer (optional, subject to availability)	75 tables and chairs, bar with dishwasher, refrigerator and hot/cold water, sound system and live monitor
Toilets	In the dressing rooms, reception area and in the lobby